

**Blank Firing Module
(BFM)**

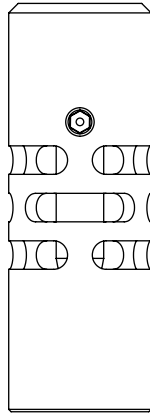

**Blank Firing Adapter
(BFA)**



**SILENT
STEEL**

INSTRUCTIONS

**Blank Firing Adapter (BFA) and
Blank Firing Module (BFM)**

BFA / BFM INSTALLATION

Rotate the blank firing suppressor onto the muzzle device thread so that the thread is at the bottom. Tighten the suppressor firmly by hand until you feel the thread bottom out. The rear edge of the suppressor should go over the o-ring and completely cover it.

The gas ports of the A2 flash hider must be closed with screws for the impulse amplification to work.

If the firearm does not load a new cartridge, the impulse amplification is too weak. Change the adjustment screw to a smaller size.

COLOR CODES FOR ADJUSTMENT SCREWS

 1,2mm  1,4mm  1,6mm  1,8mm  2,5mm

1,8 mm screw is the standard one included with the product. Additional screws can be ordered separately.

Blank Firing Adapter for Silent Steel A1/A2 flash hider	BFA-A1/A2
Blank Firing Module for Silent Steel Compact Streamer	BFM-CST
Blank Firing Module for Silent Steel Streamer	BFM-ST
Blank Streamer Yellow	BST-Y
Blank Compact Streamer Yellow	BCST-Y

SAFETY FEATURES OF SILENT STEEL BLANK FIRING ADAPTER (BFA) AND BLANK FIRING MODULE (BFM)

If an accidental live round is fired the gas tube will move forward and open the gas seal between the tube and flash hider. The high gas pressure caused by a live round will be released out to prevent damage to the firearm.

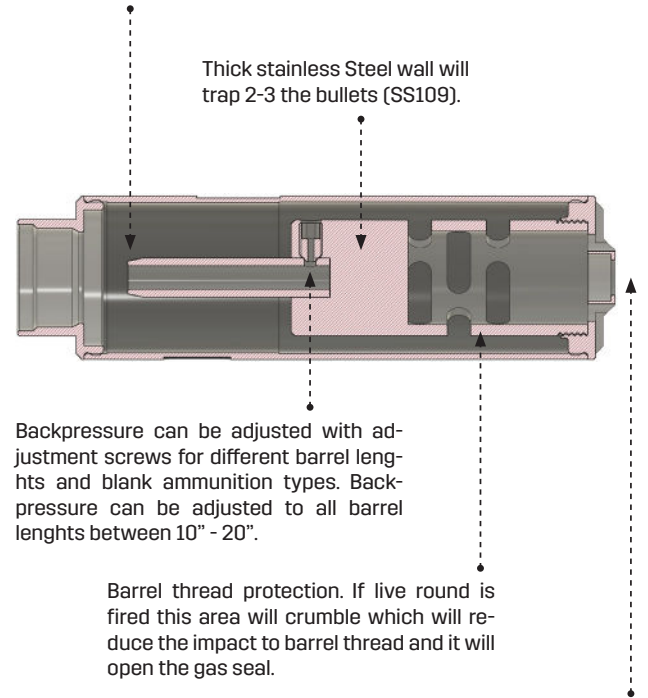

Thick stainless Steel wall will trap 2-3 the bullets (SS109).

Backpressure can be adjusted with adjustment screws for different barrel lengths and blank ammunition types. Backpressure can be adjusted to all barrel lengths between 10" - 20".

Barrel thread protection. If live round is fired this area will crumble which will reduce the impact to barrel thread and it will open the gas seal.

Gas and flame will exit from the muzzle of the suppressors.