



## **Silent Steel Safe-Guard installation**

**Quick Detach (QD) Direct Therad (DT) Quick Detach Lock (QDL) suppressors**

### **QD & DT**

Install the Safe-Guard on the Streamer suppressor. Make sure that the Safe-Guard is at the bottom and in a straight line with the suppressor. Tighten the six locking screws with a 2mm hexagonal key (included). The maximum torque is 1,5NM. Do not over tighten, as it might damage the Quick Detach thread.

### **QDL**

Slide the Safe-Guard on the suppressor. If the fitting feels tight you can open (bend) the the locking collars a little bit to prevent scratching the cerakote. Make sure that the Safe-Guard is in a straight line with the suppressor. Tighten the three screws with a 2,5mm hexagonal key (included). The maximum torque is 1,5NM.

The Silent Steel Safe-Guard is delivered with a pouch. The pouch is made from heat-resistant materials, and you can store a hot suppressor with Safe-Guard in it.

Note: Locking screws will make a mark on the cerakote surface (QD & DT)

### **QDL**

Tighten the three screws with a 2,5mm hex key (included)

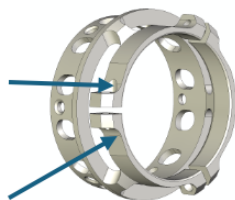

Locking collars

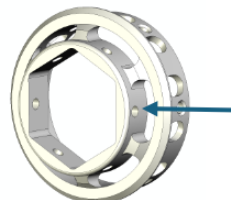

### **QD & DT**

Tighten the six locking screws with a 2mm hex key (included)